

INSTALLATION INSTRUCTIONS

FACTORY INSTALLED
ECONOMIZER ACCESSORY
MODEL 1079111/1188805/1160037/5006863

5004998-UAI-A-0115 (YFIGEC13C)

FOR 3 THRU 6.3 TON SINGLE PACKAGE EQUIPMENT MODEL AIR CONDITIONERS

Step 1:

Verify all unit parts in box. **See Figure 1.**

- 1 ea. - Hood Package: (1187183)
 - 1 ea. - Fresh Air Hood
 - 1 ea. - Fresh Air Filter
 - 1 ea. - Hardware Bag:
 - 18 ea. - Type A #10 - 16 x ½ Screws
 - 4 ea. - Self tapping #10 - 16 x ½ Screws
 - 7 ft. - ½ x ½ Gasket

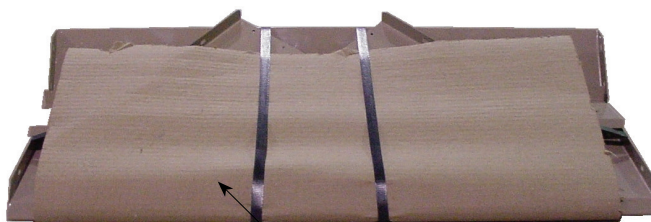

HOOD PACKAGE
Figure 1

Step 2:

Remove both horizontal return air duct cover as shown.
See Figure 2.



HORIZONTAL DUCT OPENING
Figure 2

Step 3:

Open filter access panel and remove hood package and fresh air filter. **See Figure 3.**

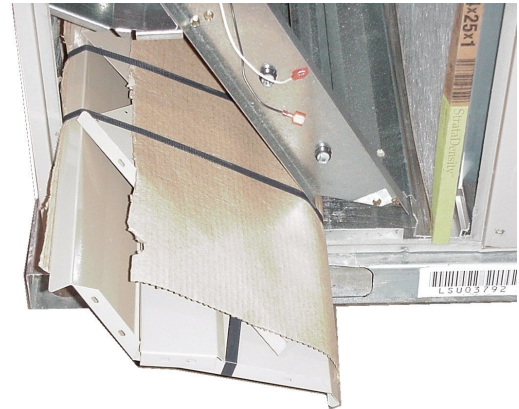

Figure 3

Step 4:

To assemble the fresh air hood the following will be needed.

- 18 ea. - Type A #10 - 16 x ½ Screws
- 7 ft. - ½ x ½ Gasket

Follow these steps:

- A. Take (4) and screw through (1) into (4) using the Type A screws.
- B. Take (3) and screw through (2) into (3) using the Type A screws.
- C. Take (5) and put to the inside of (1 & 2) and secure with Type A screws.
- D. Install filter in the hood.
- E. Take (6) and place flanges with the three holes over (1 & 2) and secure with Type A screws.
- F. Place gasket on back flanges of hood.

Set Fresh Air Hood to the side for use in Step 5.

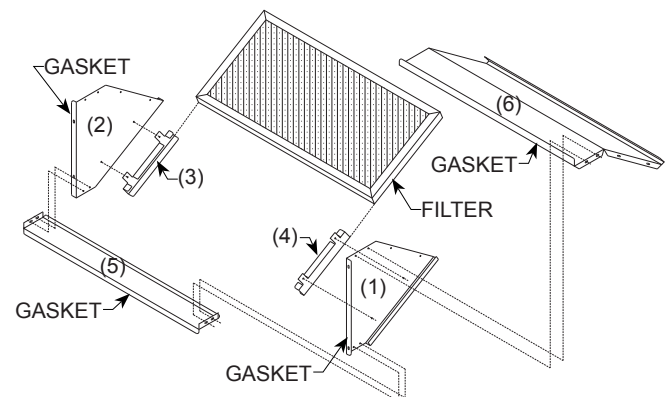

Figure 4

INSTALLATION INSTRUCTIONS

FACTORY INSTALLED
ECONOMIZER ACCESSORY
MODEL 1079111/1188805/1160037/5006863

Step 5:

Install the assembled Fresh Air Hood as shown using #10 - 16 x ½ self tapping screws. Place fresh air hood over the dimples on the face of unit and secure. **See Figure 5.**



Figure 5

Step 6:

Install the (1RD0410) Barometric Relief Hood kit as shown. **Must be purchased separate. See Figure 6.**



Figure 6